

APPROVAL - CUSTOMER NAME & SIGNATURE

DATE

REV.	DATE	BY-CHKD	REVISIONS	PART No.	"A"	"B"	"C"	"D"	"E"	"F"
				90-6-875	1.23	.75	.88	.15	.875	.16

PANEL PREPARATION

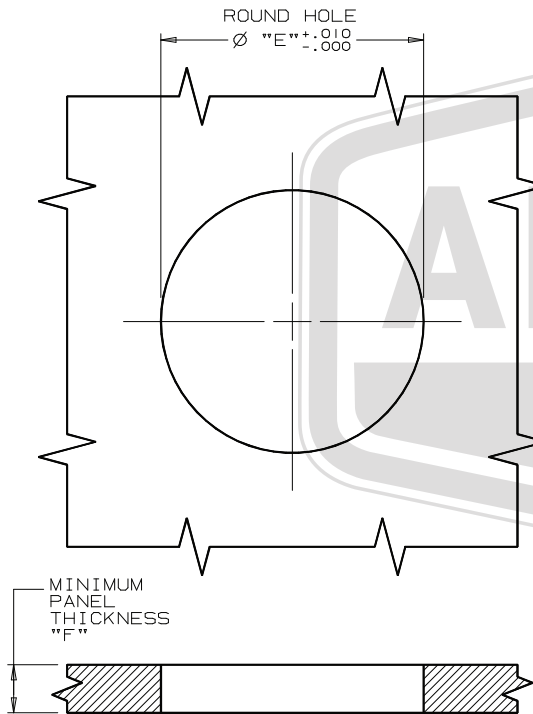

THIS SPUR WASHER IS FOR INSTALLING
 DOUBLE-D PRODUCTS IN ROUND HOLES IN
 SOFTER MATERIALS SUCH AS WOOD,
 FIBERGLASS, PLASTICS, & PARTICLE BOARD.

MATERIAL: 1050 STEEL, HARDENED
 FINISH: ZINC PLATE, CHROMATE PLUS SEALER

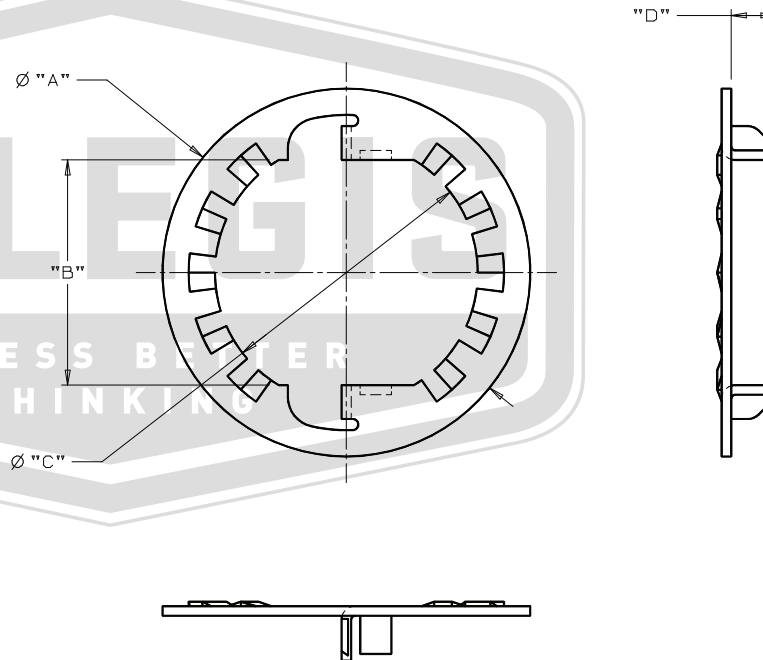

ALLEGIS

1-866-378-7550

MATERIAL:

Steel

DRAWING NO.:

90-6-875

FINISH:

Zinc Plate, bright chromate

REV.:

1:1

DATE:

5/29/2019